

FLOOR PLAN

Low Zone (5/F - 15/F)

Gross Floor Area
Approximately 11,963 sq ft

Efficiency (Whole Floor)
Approximately 81%

Clear Ceiling Height
2.9 m (5/F - 12/F)
3.3 m (15/F)

Raised Floor System
150 mm

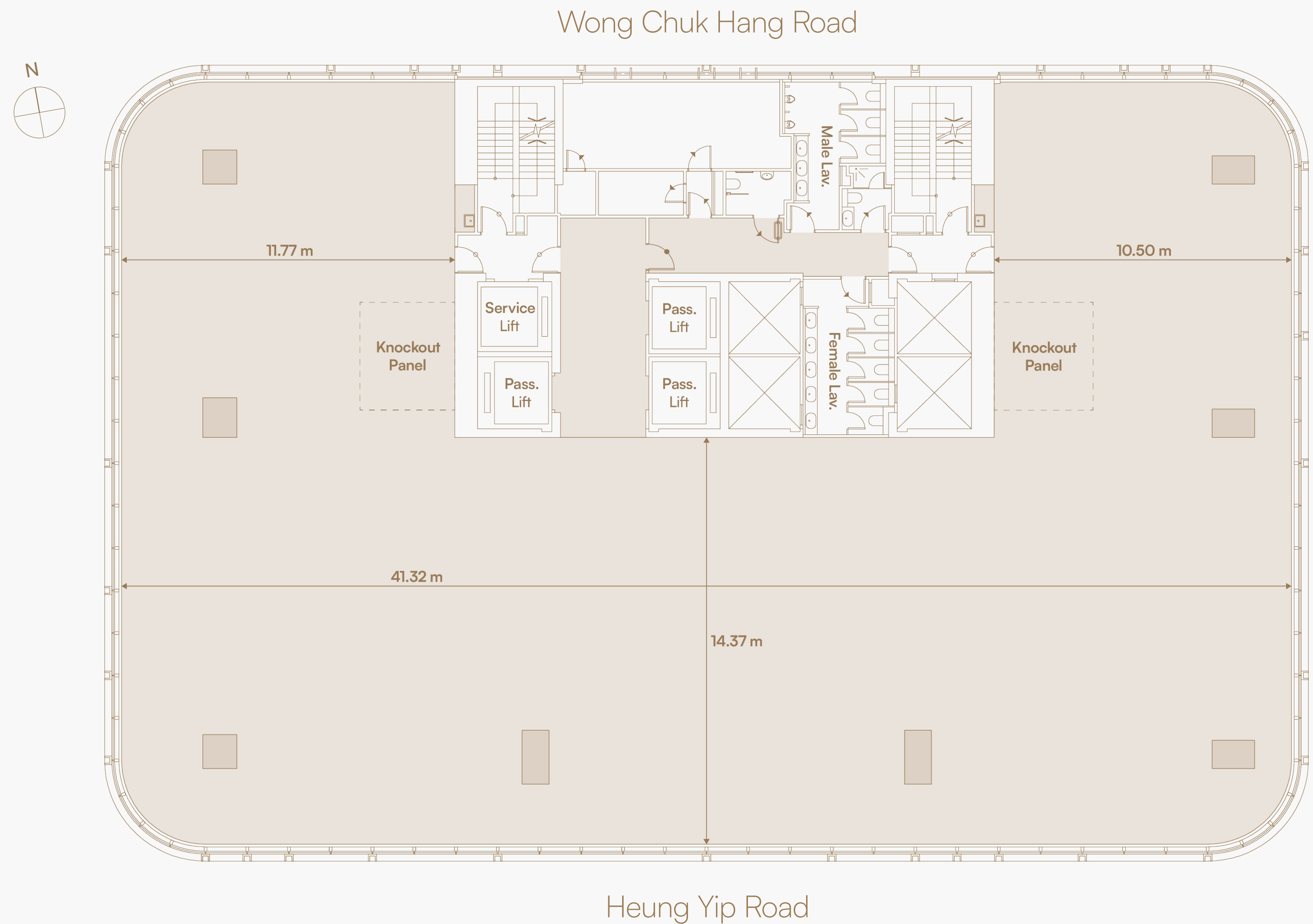

FLOOR PLAN

High Zone (17/F - 30/F)

Gross Floor Area
Approximately 11,963 sq ft

Efficiency (Whole Floor)
Approximately 81%

Clear Ceiling Height
2.9 m (17/F - 29/F)
3.3 m (30/F)

Raised Floor System
150 mm

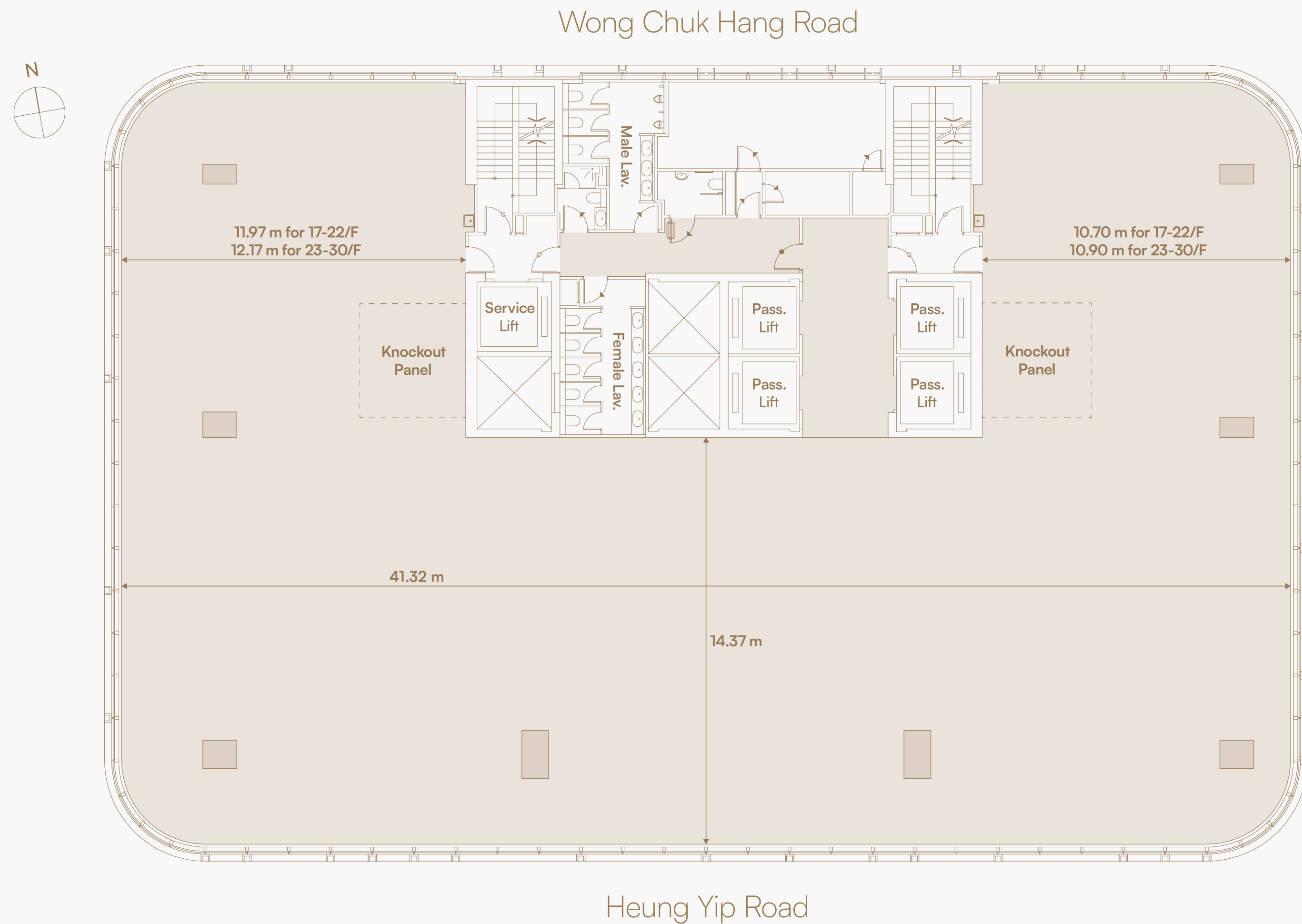

FLOOR PLAN

1/F

Gross Floor Area
 Approximately 10,749 sq ft

Efficiency (Whole Floor)
 Approximately 78%

Clear Ceiling Height
 3.4 m

Raised Floor System
 150 mm

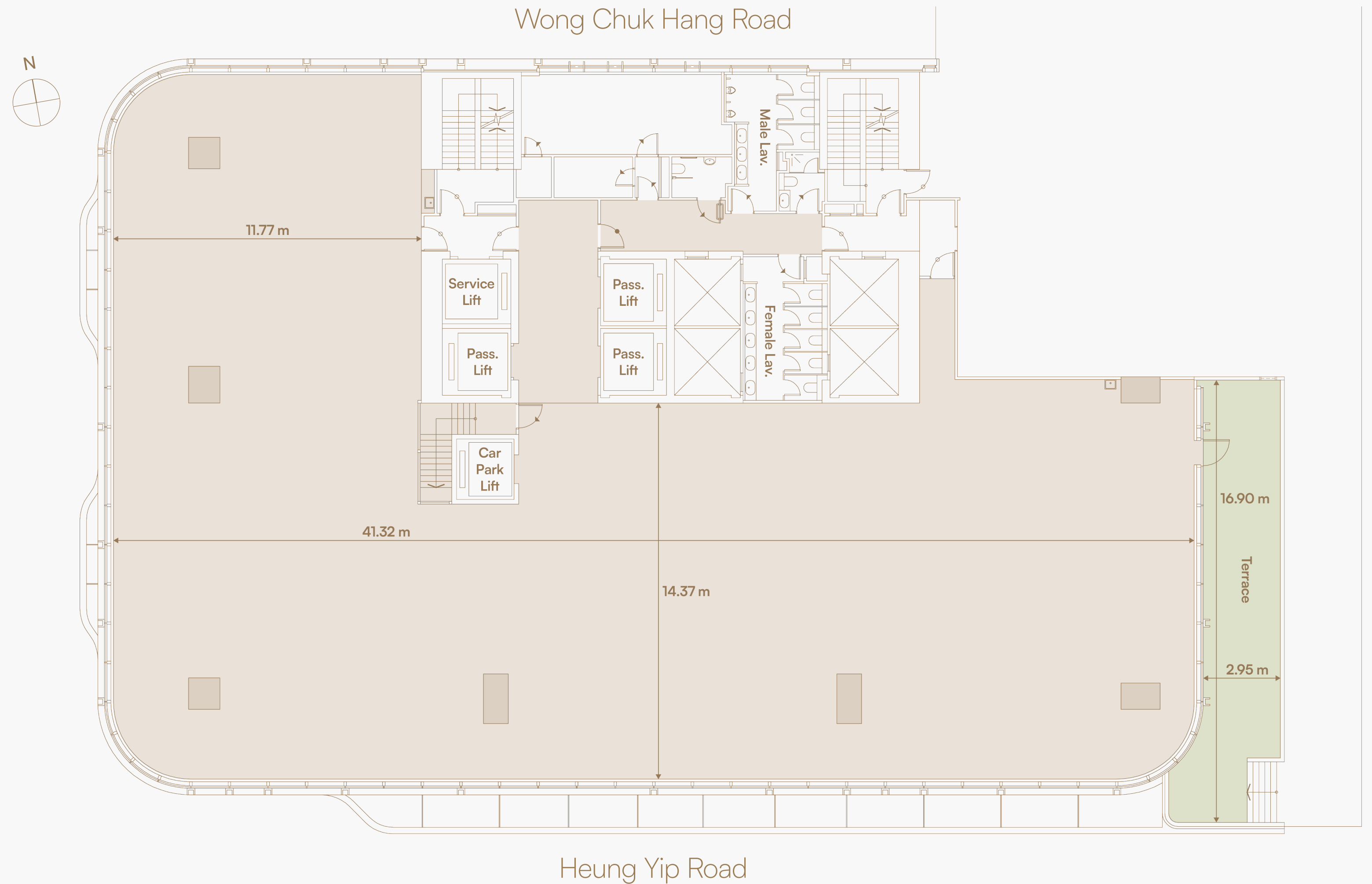

FLOOR PLAN

2/F

Gross Floor Area
 Approximately 11,963 sq ft

Efficiency (Whole Floor)
 Approximately 79%

Clear Ceiling Height
 3.4 m

Raised Floor System
 150 mm

